

Astellatech

ファインガラスカッター・アルタイル
Precision glass cutter・ULTILE

FU-100-CL
FU-200-CL
FU-300-CL
FU-400-CL
FU-500-CL

FU-100-DL
FU-200-DL
FU-300-DL
FU-400-DL
FU-500-DL

取扱説明書
User Manual

アステラテック株式会社
ASTELLATECH, INC.

各部の名称

Names of Components

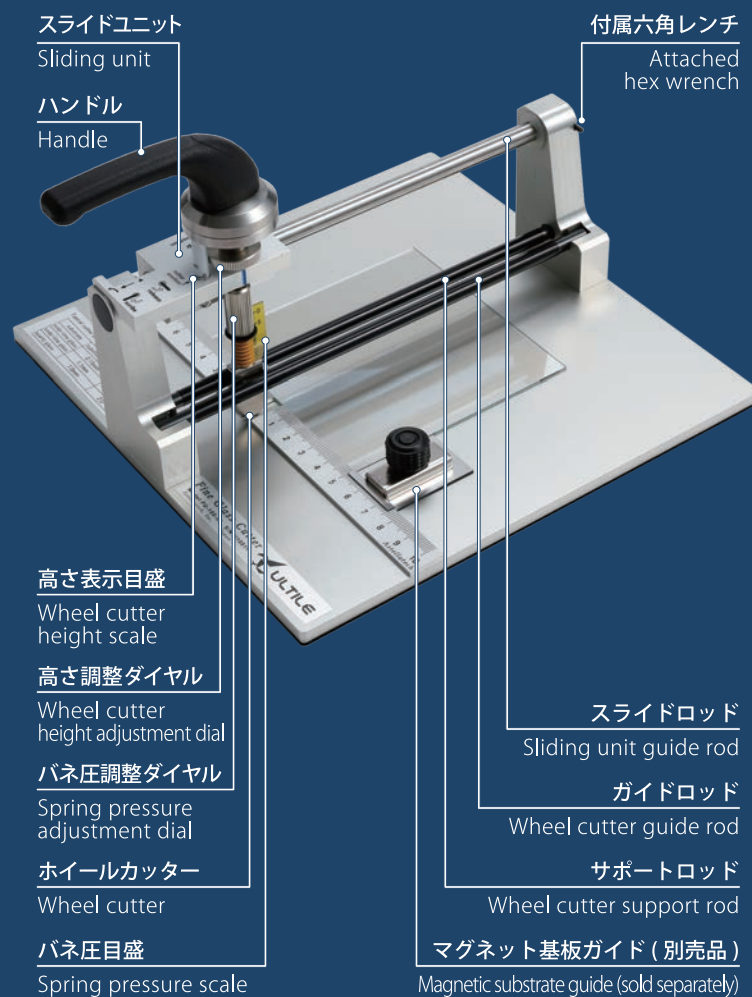

Cutting glass

1 Adjust the height of the wheel cutter

Tune the position of the wheel cutter by turning the wheel cutter height adjustment dial ①.

Check the position with the wheel cutter height scale ②.

The initial height is 0. By rotating the dial to the arrow direction ③ once, the height increases by 0.5mm.

Adjust the height 0.1 to 0.2mm less than the actual thickness of the glass to cut.

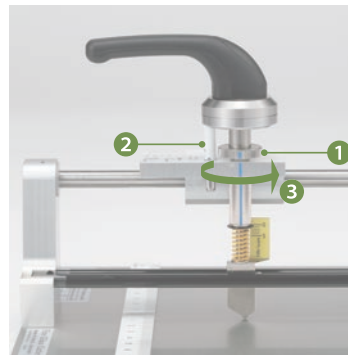

2 Tuning the pressure of the spring

Tune the pressure of the spring that pushes the wheel cutter by rotating the spring pressure adjustment dial ①.

Check the spring pressure scale by the position of the black washer ②.

By rotating the dial to the arrow direction ④ once, the pressure increases by 5N.

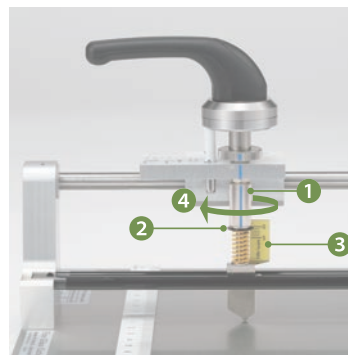

HINT!

Refer to Typical cutter pressure table at the lower left of the plate for your cutter.

3 Placing the glass

Move the sliding unit ① to the starting point of scribing. The handle ② must be directing opposite to the starting point. The wheel cutter is able to cut the substrate with this handle direction. Next, place the glass substrate correctly to the position to cut and hold it by your hand.

HINT!

For precisely determining the cutting position, use of magnetic substrate guide ④ (sold separately) is recommended.

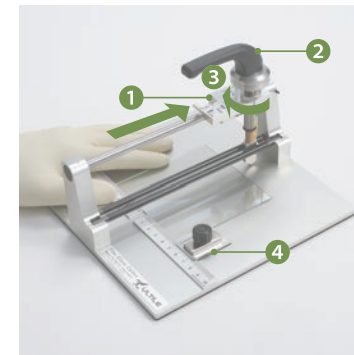

4 Scribing

Scribe the glass by pulling the handle ① slowly from the starting point to the end of the substrate. The faster the scribing, the shallower the fissures to be made. If the fissure is too shallow and the glass does not split easily, go back to Step1 and repeat the procedure.

HINT!

The depth of the fissure depends on the height of the wheel cutter and the pressure of the spring. If the wheel cutter height is too low, the cutter may get too much pressure when it gets on the substrate and may cause the edge to chip. If you don't want the chipping, place the dummy glass on top and bottom of the actual glass substrate.

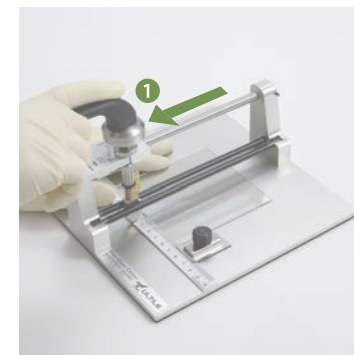

5 Splitting the glass

Carefully take the glass out of the precision glass cutter. Hold the glass evenly at the right and left of the fissure with your fingers. Split the glass by applying force to the arrows directions ①.

HINT!

If the depth of the fissure is not uniform throughout the substrate, apply force at the place where the fissure is deeper.

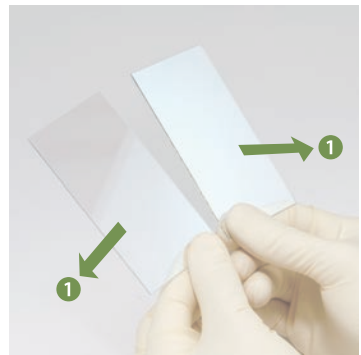

Scribing the same substrate successively

Temporarily turn the handle ① to the direction ② 90° from the scribing position.

The wheel cutter raises 0.7mm and the cutter becomes free to move. Move the wheel cutter to the initial position ③ of the glass cutting. Move the glass, set it to the next position to scribe, and follow the procedure from Step 3 above to scribe. Repeat the procedures to scribe several times on the same substrate.

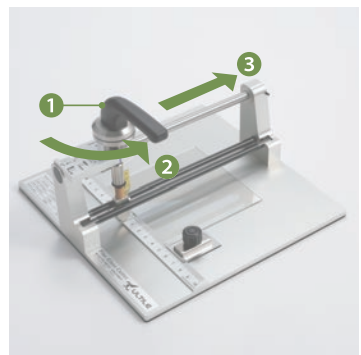

Replacing wheel cutter

1 Rotate the wheel cutter height adjustment dial ① and the spring pressure adjustment dial ② to the original point of 0. By doing so, the blue lines of each adjustment dial and the slide unit ③ line straight.

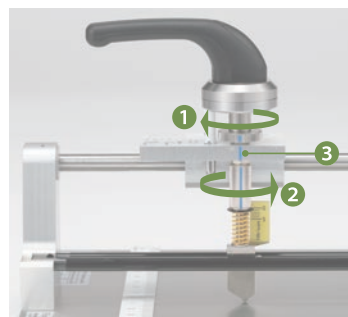

2 Move the slide unit to the wheel cutter replacement position (to the direction ①) and remove the wheel cutter guide rod ②.

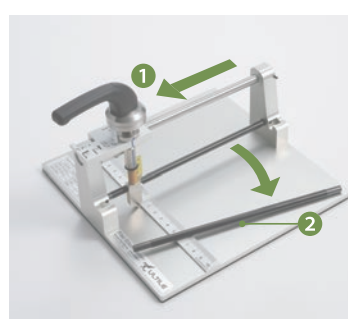

3 Turn the handle over 90° to the left ①.

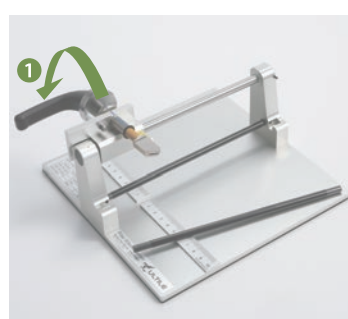

4 Loosen the screw ② that fixes the wheel cutter using the attached hex wrench ① and remove the wheel cutter.

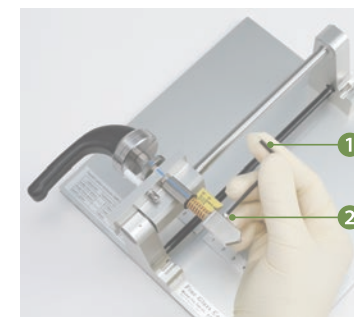

5 When inserting a new wheel cutter, hold the handle lightly not to let it stick out to the left. The cutter stays naturally with magnetic force when it is inserted in the shaft. After positioning the wheel cutter correctly, tighten the screw using the attached hex wrench ①.

HINT!

Push the wheel cutter lightly so that the spring pressure is not lost when tightening the screw.

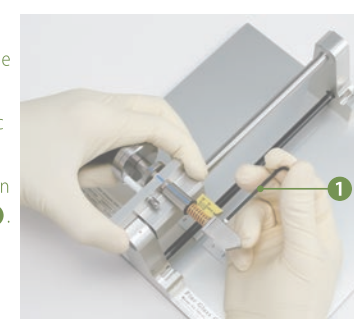

6 Return the handle to the scribing position and set the wheel cutter guide rod ②.

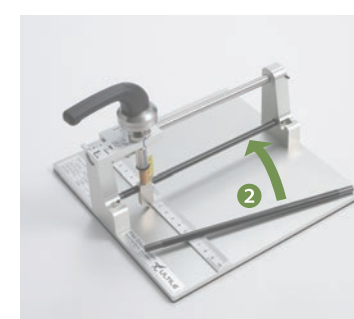

Precautions for use

- ⚠ Wheel cutters wear by use. Replace it when it becomes dull.
- ⚠ To avoid the spring to be degraded, turn the spring pressure dial to the initial position of 0 after using the precision glass cutter before storing it.
- ⚠ For the long use of this product, wipe the sliding unit guide rod periodically and put grease to replenish it in the slide unit.
- ⚠ Do not disassemble the product needlessly.

Visit our website for more information on Precision Glass Cutter.

Instruction movie is also available on this site.



astellatech glass cutter

Search

http://www.astellatech.co.jp/glass_cutter.html

Contact us when you have inquiries or you want to place an order for the parts sold separately.

e-mail contact@astellatech.co.jp

ASTELLATECH, INC.

Room 301, Meiji University Center for Collaborative Innovation and Incubation,
2-3227 Mita, Tama-ku, Kawasaki-shi, Kanagawa 214-0034, JAPAN